

TF35 HYDRAULIC TABLE TRUCK PARTS

TF 35 Hydraulic Table Truck  
(Cable Release)

# INSTRUCTION MANUAL

## HYDRAULIC TABLE TRUCK



**Model: TF 35**

# TF 35 Hydraulic Table Truck (Cable Release)

## I. Use & applicable range

It is a convertible vehicle using for lifting and transporting in workshop, warehouse and wharf, etc.

## II. Basic Data:

Model	TF 35
Load Capacity	350kgs
Lift Height	1300mm
Lowest Height	345/405mm
Table Dimensions	905×512×55mm
Packing Dimensions	1000×530×360/420mm
Net Weight	113kgs

## III. Installing

1. Install the handle (#14) on the frame seat (#20), and fix them by two M12 bolts.
2. Insert the foot pedal rod (#64) into the hole of the foot pedal holder (#60), and fix them by M8 bolt.
3. Insert the brake thread (#18) into the press bolt (#48), and fix them by M8 nut.

## IV. Using

1. Test the cart before using it. Firstly step the foot pedal rod to lift the table to the max height, and then release the limit oil valve to check whether the cart is ok.
2. Please fix the cart and to brake the wheel before loading.
3. Adjust the table's height by step the foot pedal lift up and down to load or unloading in its rated loading.
4. When lower the table, draw up the handle.

## V. Warning

- (1) Operate strictly according to the instruction manual.
- (2) Do not use the cart on slop.
- (3) Do not allow people to sit or ride on the cart.
- (4) Keep feet and hand away from under the lowering table. Suggest to wear safety shoes during operation.
- (5) Do not transport the loads during the raising process.
- (6) Do not random regulate the safety valve.
- (7) The maintenance is to be performed by the professional person
- (8) Failure to operate the cart will cause the damage to the person health or property loss.
- (9) The cart must used in the rated capacity, it is not permit to load the heavy goods that the rated capacity of the cart.

# TF35 HYDRAULIC TABLE TRUCK PARTS

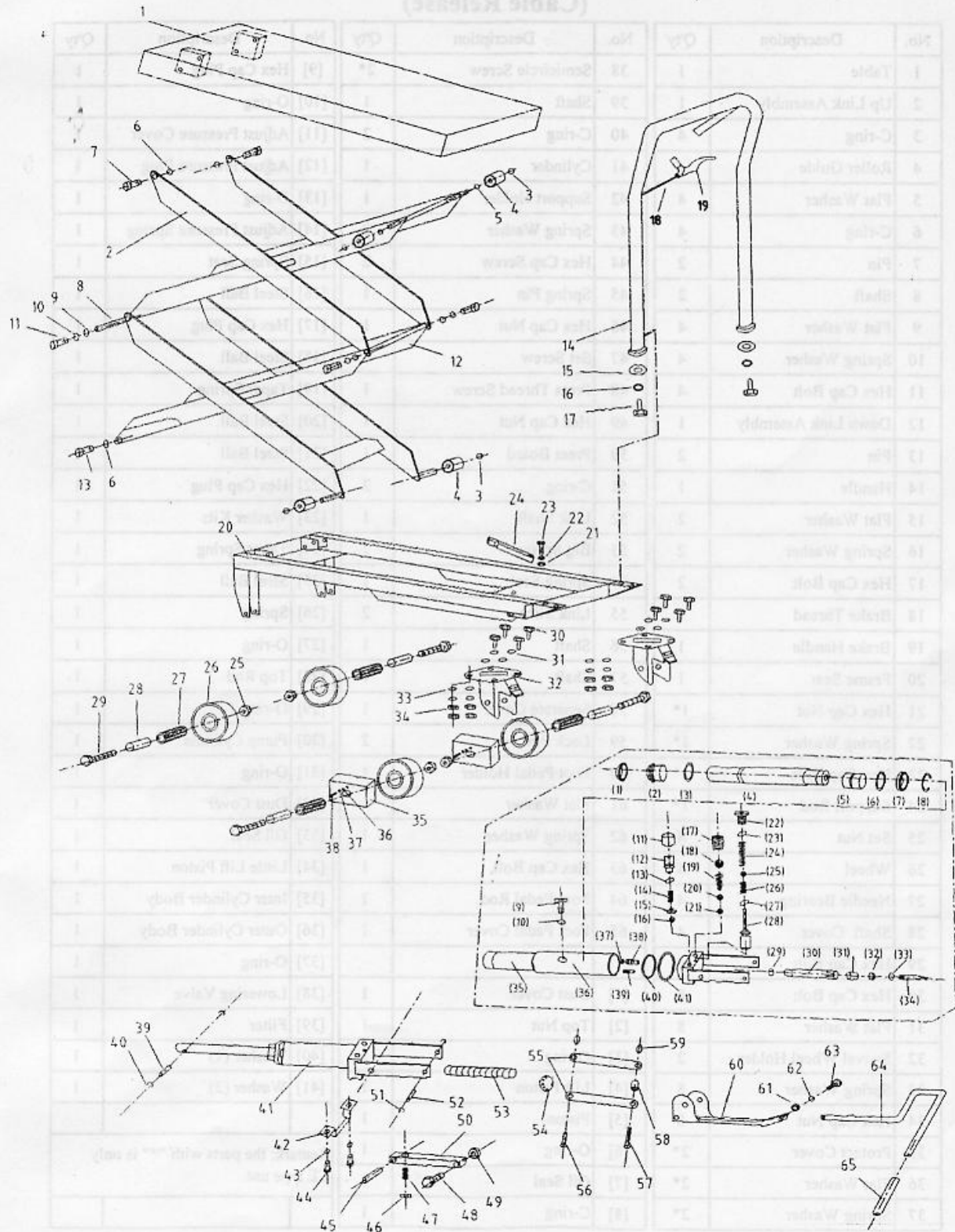

No.	Description	Q'ty
1	Table	1
2	Up Link Assembly	1
3	C-ring	4
4	Roller Guide	4
5	Flat Washer	4
6	C-ring	4
7	Pin	2
8	Shaft	2
9	Flat Washer	4
10	Spring Washer	4
11	Hex Cap Bolt	4
12	Down Link Assembly	1
13	Pin	2
14	Handle	1
15	Flat Washer	2
16	Spring Washer	2
17	Hex Cap Bolt	2
18	Brake Thread	1
19	Brake Handle	1
20	Frame Seat	1
21	Hex Cap Nut	1*
22	Spring Washer	1*
23	Hex Cap Bolt	1*
24	Support Rod	1*
25	Set Nut	4
26	Wheel	4
27	Needle Bearing	4
28	Shaft Cover	4
29	Hex Cap Bolt	4
30	Hex Cap Bolt	8
31	Flat Washer	8
32	Swivel Wheel Holder	2
33	Spring Washer	8
34	Hex Cap Nut	8
35	Protect Cover	2*
36	Flat Washer	2*
37	Spring Washer	2*

No.	Description	Q'ty
38	Semicircle Screw	2*
39	Shaft	1
40	C-ring	2
41	Cylinder	1
42	Support Holder	1
43	Spring Washer	2
44	Hex Cap Screw	2
45	Spring Pin	1
46	Hex Cap Nut	1
47	Set Screw	1
48	Press Thread Screw	1
49	Hex Cap Nut	1
50	Press Board	1
51	C-ring	2
52	Link Shaft	1
53	Big Spring	1
54	Spring Seat	1
55	Link Slice	2
56	Shaft	1
57	Shaft	1
58	Separate Cover	1
59	Lock Pin	2
60	Foot Pedal Holder	1
61	Flat Washer	1
62	Spring Washer	1
63	Hex Cap Bolt	1
64	Foot Pedal Rod	1
65	Foot Pedal Cover	1
[1]	Dust Cover	1
[2]	Top Nut	1
[3]	O-ring	1
[4]	Lift Piston	1
[5]	Piston	1
[6]	O-ring	1
[7]	Oil Seal	1
[8]	C-ring	1

No.	Description	Q'ty
[9]	Hex Cap Plug	1
[10]	O-ring	1
[11]	Adjust Pressure Cover	1
[12]	Adjust Pressure Plug	1
[13]	O-ring	1
[14]	Adjust Pressure Spring	1
[15]	Spring Seat	1
[16]	Steel Ball	1
[17]	Hex Cap Plug	1
[18]	Steel Ball	1
[19]	Taper Spring	1
[20]	Steel Ball	1
[21]	Steel Ball	1
[22]	Hex Cap Plug	1
[23]	Washer Kits	1
[24]	Taper Spring	1
[25]	Steel Ball	1
[26]	Spring	1
[27]	O-ring	1
[28]	Top Rod	1
[29]	O-ring	1
[30]	Pump Cylinder	1
[31]	O-ring	1
[32]	Dust Cover	1
[33]	Oil Seal	1
[34]	Little Lift Piston	1
[35]	Inter Cylinder Body	1
[36]	Outer Cylinder Body	1
[37]	O-ring	1
[38]	Lowering Valve	1
[39]	Filter	1
[40]	Washer (1)	1
[41]	Washer (2)	1
Remark: the parts with "*" is only CE type use.		